

Single Tamper Resistant Wall Enclosure with One Interchangeable Module Supports up to 16 Fibres

V.3.4

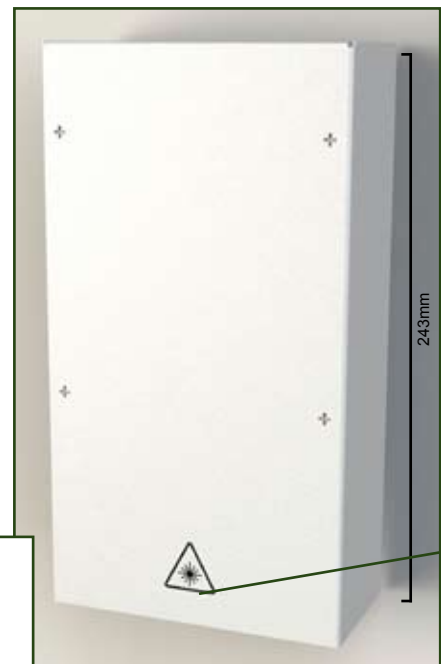

Supports UP TO 16 Fibres

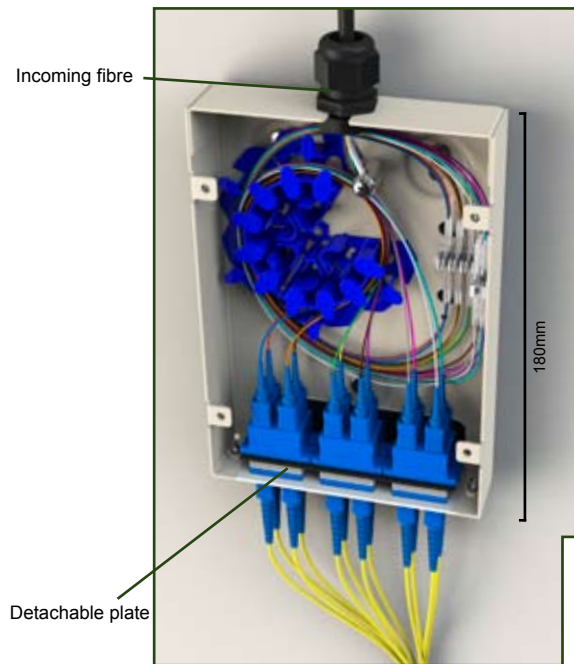
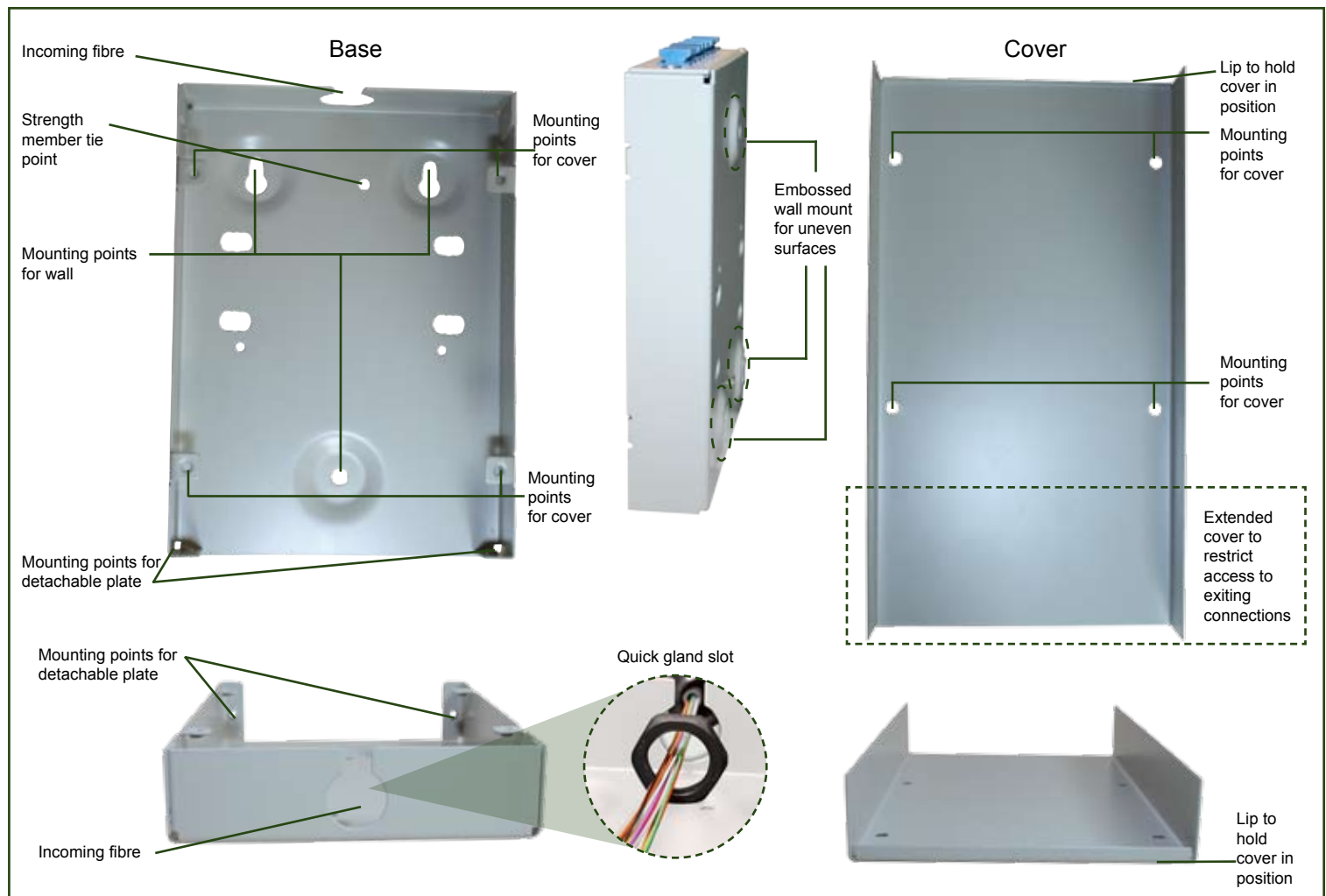

+44 (0) 870 127 3330



+44 (0) 870 127 3331



sales@fibrefab.com



www.fibrefab.com

Single Tamper Resistant Wall Enclosure with One Interchangeable Module Supports up to 16 Fibres

V3.4

Description

Our tamper resistant wall enclosures can be assembled to fit any installation requirements, offering a wide range of flexibility to the end user. You can choose to have the enclosure pre-loaded with adaptors only or fully loaded with pigtails to save valuable time on site. The standard enclosure includes the newly designed speedway spool to protect the bend radius of each fibre, cable gland for incoming fibre and splice holders.

Features/Benefits

- ▶ Cable management kit included
- ▶ Interchangeable modular adaptor plate (please see page 3)
- ▶ Fitted with security screws
- ▶ Single or double module versions available
- ▶ Extended cover to restrict access to exiting connections
- ▶ Strength member tie position
- ▶ Suitable for pre-terminated cables or splicing
- ▶ IP20

Applications

- ▶ Internal application
- ▶ Data Centre or telecommunications networks
- ▶ For use in multi dwelling units or demarcation points in a network

Technical Specification

DESCRIPTION	
Height	243mm
Width	133mm
Depth	38mm
Net weight	0.8kg
Packaged weight	0.9kg
Packaged dimensions	265mm (H) x 140mm (W) x 45mm (D)
Suitable for adaptor type	ST, FC, SC Simplex, LC Duplex, E2000
Number of fibres	Up to 16 fibres
Material	Cold-rolled steel
Material thickness	Tray: 1.2mm
Material coating	Powder coating
Colour	Grey RAL 7035 Black 9004
Operating temperature	-40°C to +60°C
Designed in accordance with	TIA/EIA 568.C, ISO/IEC 11801, EN50173, IEC60304, IEC61754, EN297-1
Compliant to	Compliant to

Technical Drawing

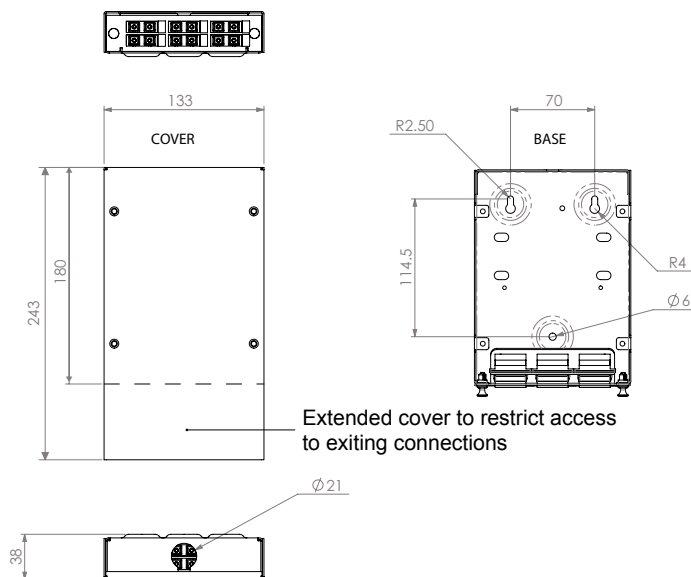

Ordering Information

DESCRIPTION	PART NO.
Single LGX Wall Enclosure - Grey	TW07XXX00
Single LGX Wall Enclosure - Black	TW09XXX00

Optional Extras:

Front plate and adaptors (see page 3), splice protector 45mm, pigtails.
For more details, head to www.fibrefab.com



+44 (0) 870 127 3330



+44 (0) 870 127 3331



sales@fibrefab.com



www.fibrefab.com

Single Tamper Resistant Wall Enclosure with One Interchangeable Module Supports up to 16 Fibres

V.3.4

For all of your variations

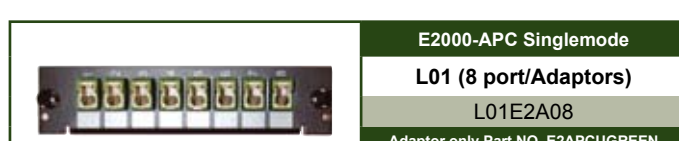
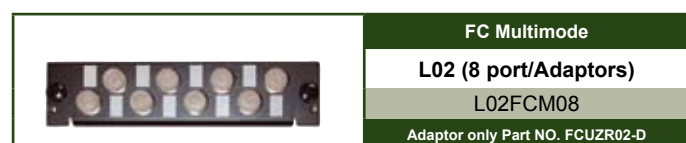
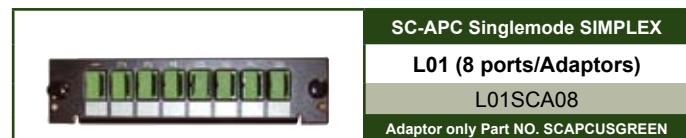
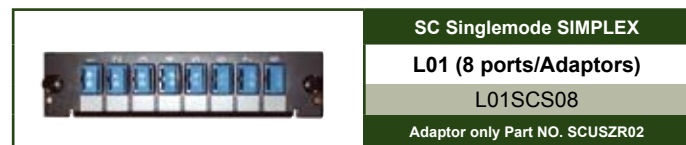

To order the front plate in grey colour, please add /G on the end of the part numbers listed above.

Example: L01E2A08/G



+44 (0) 870 127 3330



+44 (0) 870 127 3331



sales@fibrefab.com



www.fibrefab.com